

# PERMIT

CITY OF NAPOLEON, OHIO — DEPT. OF BUILDING & ZONING

255 W. Riverview Avenue, Napoleon, Ohio 43545 (419) 592-4010

Permit No. 503 Date Sept. 8, 1982  
Job Location 330 Rohrs St. Valuation \$ 3,000.00  
Owner Clarence R. Adams Address 330 Rohrs St.  
Contractor Clarence R. Adams Telephone No. 592-5333  
Address 330 Rohrs St., Napoleon, Ohio  
Electric Contractor Clarence R. Adams  
Plumbing Contractor \_\_\_\_\_  
Mechanical Contractor \_\_\_\_\_

**This permit is issued for work described in the plans, specifications, and/or application submitted, as approved by the Building Commissioner of the City of Napoleon, Ohio. Work shall conform to all pertinent construction and land use Codes and Ordinances.**

### Work Information:

Residential  Commercial \_\_\_\_\_ Industrial \_\_\_\_\_  
No. dwelling units  
New Construction  Addition \_\_\_\_\_ Remodel \_\_\_\_\_  
Brief Description of Work new garage

ISSUED BY Richard S. Hayman DEPT. OF BUILDING & ZONING  
Building Official

**It is the owners or contractors responsibility to call the Building Department for the following (x) inspections:**

- Footing excavation prior to placing concrete.
- Footing drains and foundation prior to backfill.
- Prepared sub-grade prior to placing concrete floor slab.
- Sanitary sewer
- Rough-in electrical, plumbing and service framing prior to installing wall board.
- Final electrical, plumbing and heating.
- Final building inspection, prior to occupancy.

**Permit is not valid until all fees are paid in full, and shall be void if work is not started within six months of date above.**

### PERMIT & FEES

Building Permit	\$ <u>12.00</u>
Electrical Permit	\$ <u>7.00</u>
Plumbing Permit	\$ _____
Mechanical Permit	\$ _____
Demolition Permit	\$ _____
Zoning Permit	\$ _____
Sign Permit	\$ _____
Water Tap	\$ _____
Sewer Tap	\$ _____
Temp. Elec.	\$ _____
Other _____	\$ _____
<b>TOTAL FEES</b>	\$ <u>19.00</u>
<b>LESS FEES PAID</b>	\$ <u>19.00</u>
<b>BALANCE DUE</b>	\$ <u>-0-</u>

**PAID**

SEP 8 1982



CITY OF NAPOLEON  
BUILDING INSPECTION DEPARTMENT  
APPLICATION FOR BUILDING PERMIT  
(Please print or type)

SEP 8 1982

CITY OF NAPOLEON

The undersigned hereby makes application for construction, installation, or alteration work as herein specified, agreeing to do all such work in strict accordance with the City of Napoleon's adopted Building Codes.

Location of project 330 Robt St. Cost of project 3000.00

Owner's Name Clarence R Adams Address 330 Robt St.

Contractor Clarence R Adams Telephone No. 592-5333

Address 330 Robt St. Napoleon, Ohio

Lot Information: (Not required for siding job)

Lot No. 42 Subdivision Springwell Addition

Zoning District A Lot Size 20 ft. X 24 ft. Area 480 sq. ft.

Setbacks: Front 50 Right Side 5 Left Side 5 Rear 10

Work Information:

Residential yes Commercial \_\_\_\_\_ Industrial \_\_\_\_\_

New Construction yes Addition \_\_\_\_\_ Remodel \_\_\_\_\_

Accessory Building yes Siding Aluminum  
(Specific Type)

Brief Description of Work:-----

Size: Length 24 Width 20 No. of Stories 1

Area: 1st Floor \_\_\_\_\_ sq. ft. Basement \_\_\_\_\_ sq. ft.

2nd Floor \_\_\_\_\_ sq. ft. Accessory Bldg. 480 sq. ft.

3rd Floor \_\_\_\_\_ sq. ft. Other \_\_\_\_\_ sq. ft.

Additional Information: \_\_\_\_\_

APPLICATION FOR PERMIT SHALL BE ACCOMPANIED BY TWO COMPLETE SETS OF PLANS INCLUDING: ELEVATIONS, FLOOR PLANS, CROSS SECTIONS AND PLOT PLAN. IF ADDITION OR REMODELING, SHOW ALL EXISTING STRUCTURES AND THEIR SIZE AND LOCATION. ALL PLANS SHALL BE DRAWN TO SCALE.

Date 9-7-82 Applicant's Signature Clarence R Adams

PERMIT NO. 503  
PERMIT FEE \$ 12.00



PAID

CITY OF NAPOLEON

SEP 8 1982

ELECTRICAL PERMIT APPLICATION

CITY OF NAPOLEON

PROJECT LOCATION 330 Robus.

OWNER Clarence Adams CONTRACTOR Same

ADDRESS 330 Robus ADDRESS \_\_\_\_\_

PHONE 592 5333 PHONE \_\_\_\_\_

LOT NO. 42 ADDITION Springwells Add.

SERVICE INFORMATION

RESIDENTIAL

COMMERCIAL \_\_\_\_\_

INDUSTRIAL \_\_\_\_\_

NEW 100AMP

CHANGE \_\_\_\_\_

SERVICE SIZE \_\_\_\_\_

OVERHEAD

UNDERGROUND \_\_\_\_\_

MAIN DIS. EXT. \_\_\_\_\_

INT.

TEMP. ELECT. No

(yes or no)

PANEL INFORMATION MINIMUM

#12 AWG Wire for receptical circuits.

#14 AWG Wire for light circuits.

All circuits shall be listed on the fuse or breaker or on the inside of panel door.

PERMIT FEES Garage will have disconnect and 2 circuits

RESIDENTIAL

BASE FEE	\$5.00
PLUS \$1.00 PER CIRCUIT	<u>2.00</u>
TEMP. ELECT. \$10.00	_____

COMMERCIAL

PLANS W/SEAL PER STRUC,	\$12.00
PLUS \$.40 PER 100 SQ.FT.	_____

PLANS, NO SEAL \$35.00 PER HOUR

PLUS \$ .55 per 100 SQ.FT.

IN THE ABSENCE OF A DETAILED BLUE PRINT DRAWING, PLEASE MAKE AN ISOMETRICAL DRAWING OF THE PROPOSED WORK. (TWO COMPLETE SETS)

LIGHTS AND APPLIANCES SHALL BE ON SEPERATE CIRCUITS. LIMIT EACH CIRCUIT TO NOT MORE THAN 1200 WATTS.

GROUND FAULT CIRCUIT INTERRUPTER PROTECTION IS REQUIRED ON ALL 120 VOLT SINGLE PHASE, 15 AND 20 AMP. CIRCUITS WHICH ARE PART OF A TEMPORARY ELECTRIC SERVICE: AND ALSO ON BATHROOM, OUTDOOR AND GARAGE RECEPTICALS IN ALL DWELLING UNITS.

GROUNDING

RESIDENTIAL SERVICE GROUNDING SHALL CONSIST OF TWO SEPERATE PATHS TO GROUND. 1. A DRIVEN GROUND ROD. 2. TO THE SERVICE SIDE OF THE WATER SERVICE. MINIMUM GROUNDING WIRE SIZE SHALL BE #6 AWG.

METER SOCKET

METER SOCKETS WILL BE ISSUED BY THE CITY OF NAPOLEON ELECTRIC DEPT. AT NO CHARGE ONLY WITH A METER RELEASE SLIP FROM THE BUILDING DEPT.

INSPECTIONS REQUIRED: ROUGH IN AND FINAL.

DATE 9-8-82 CONTRACTOR SIGNATURE Clarence Adams

PERMIT NO. 503

PERMIT FEE \$ 7.00



CITY OF NAPOLEON  
BUILDING DEPT.

Plan Approval  
By *ABH*  
Date *8-8-88*  
Permit *503*

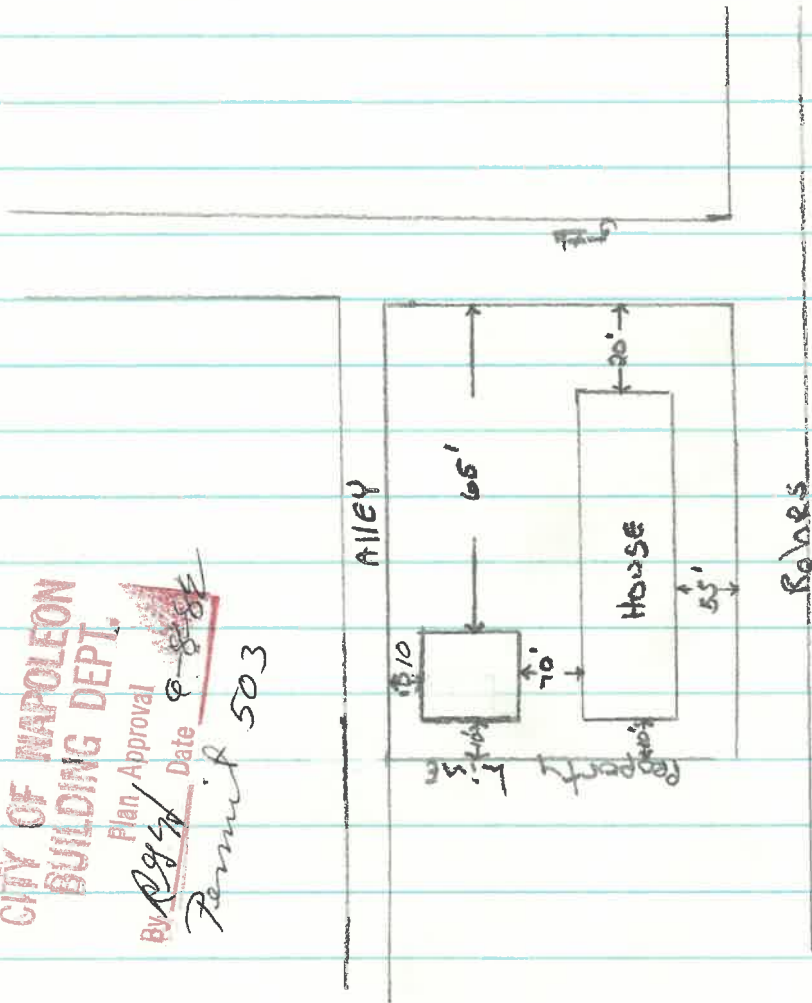

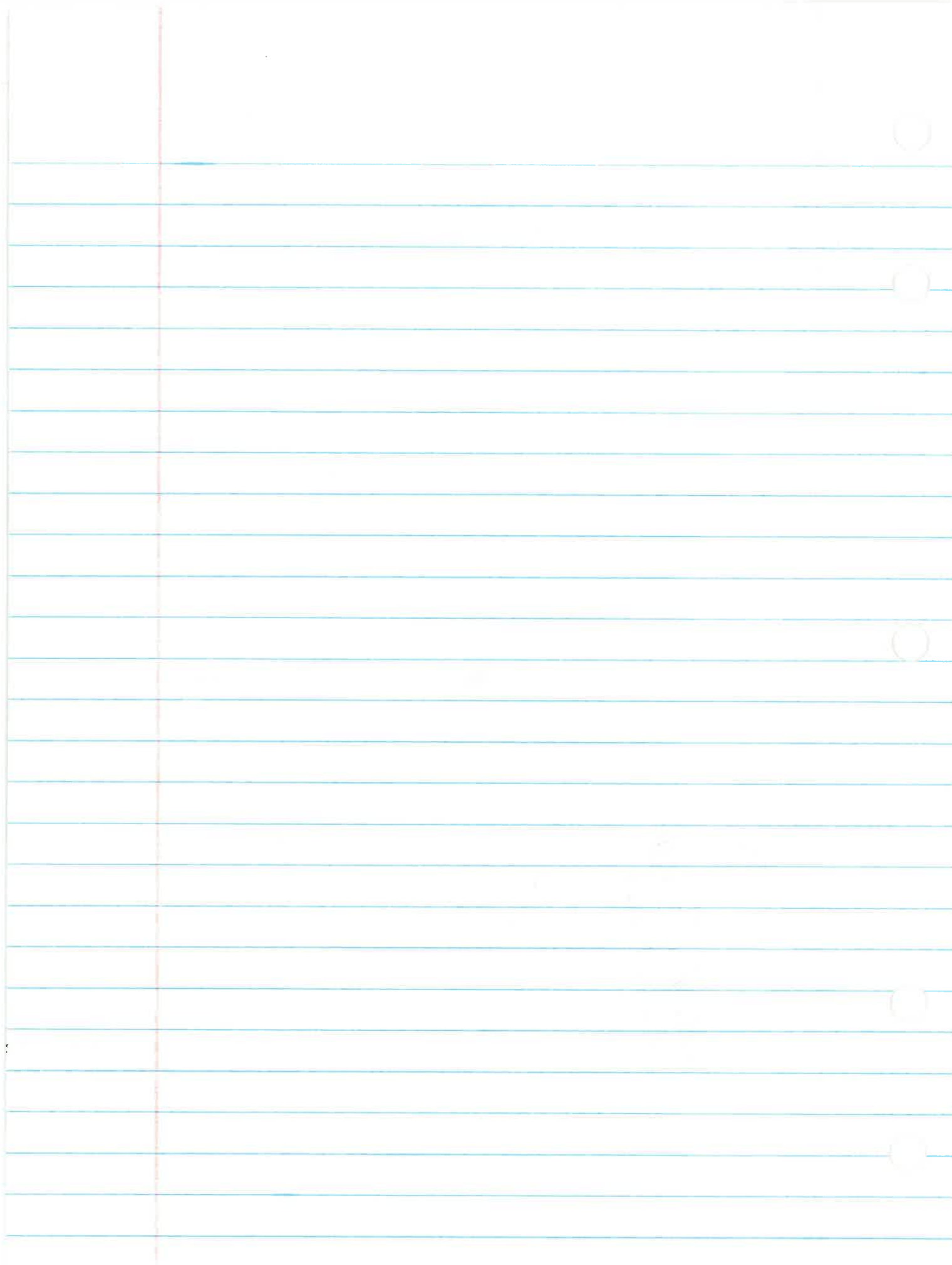



CITY OF NAPOLEON  
BUILDING DEPT.

Plan Approval

By *RXX* Date 7-8-84

Permit 503

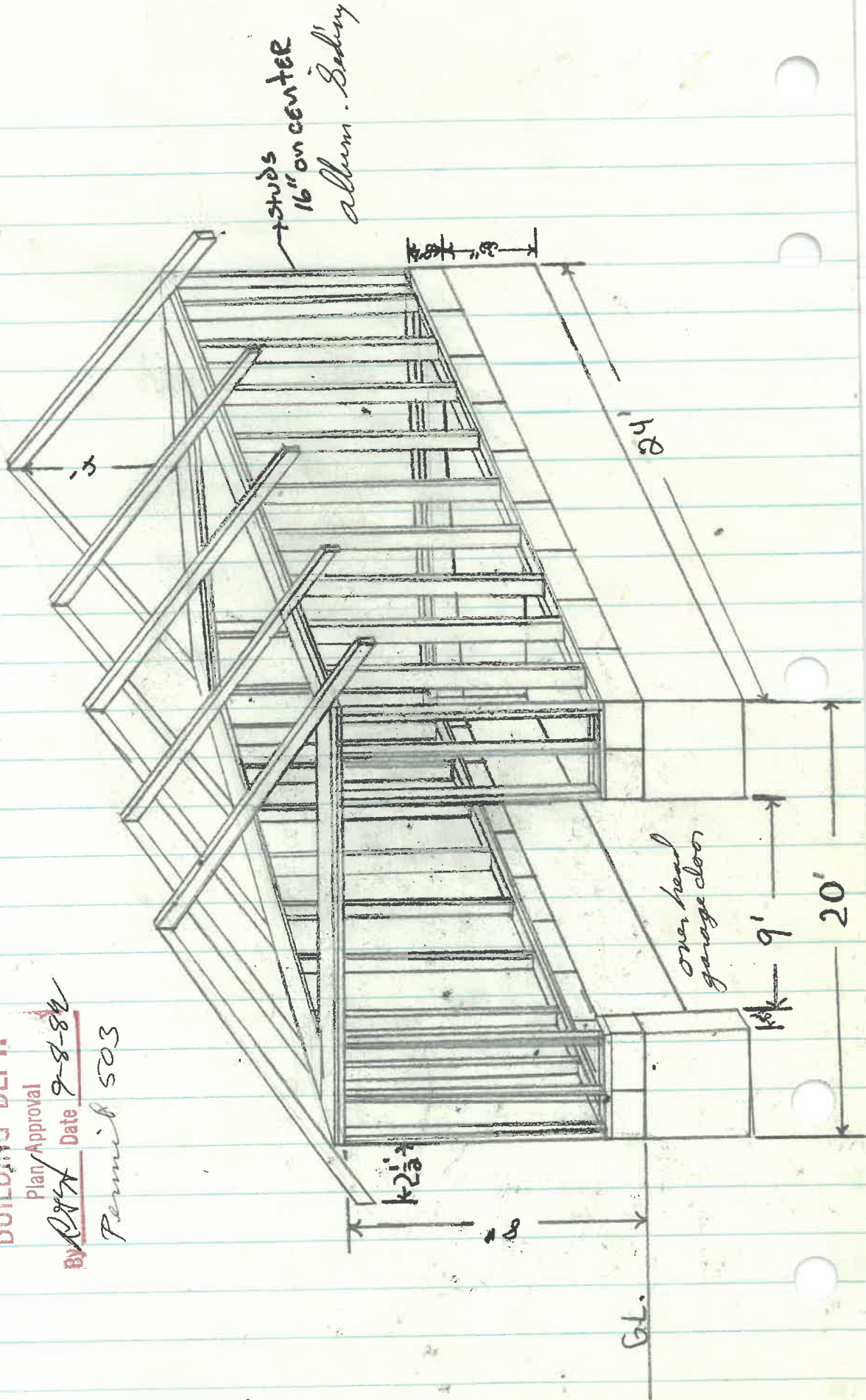

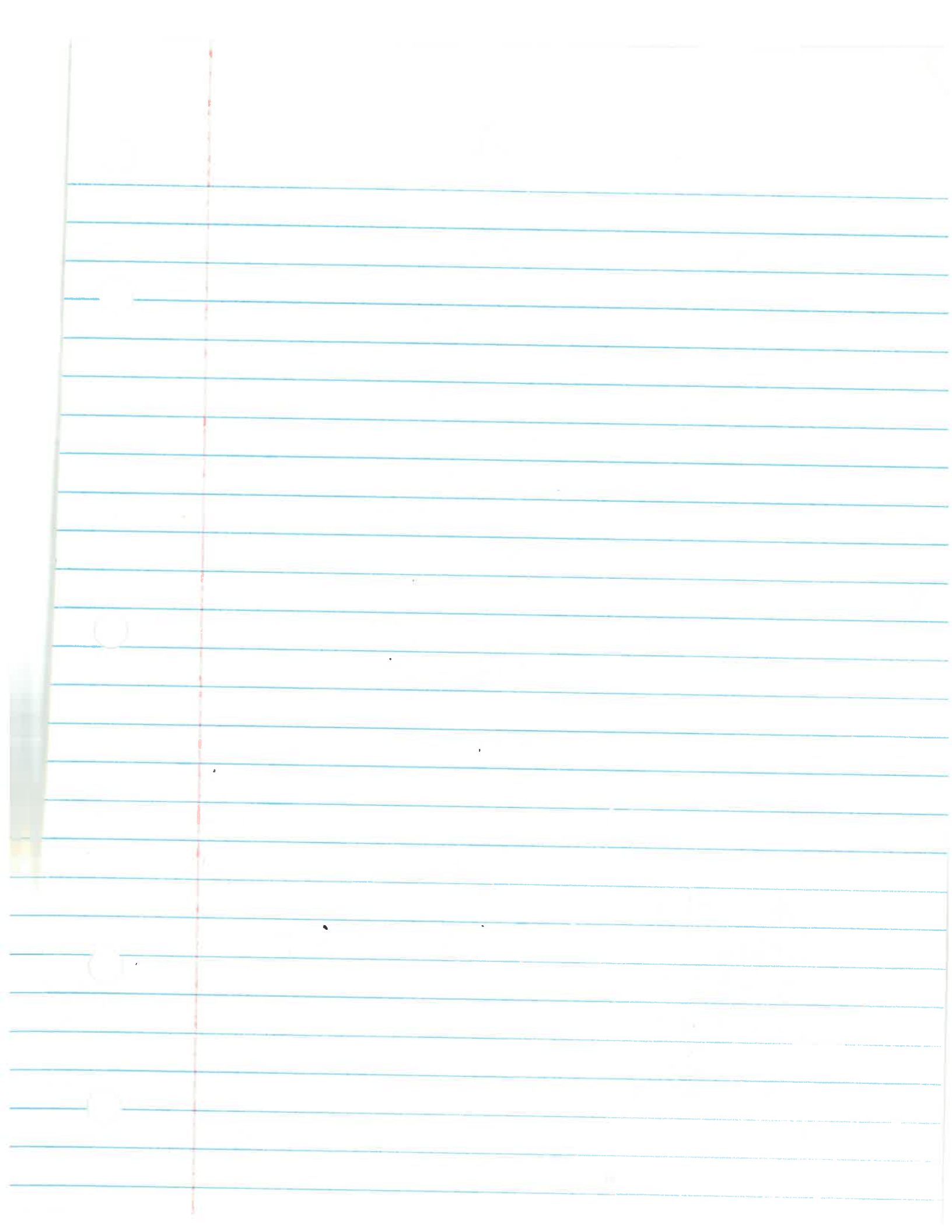

# PERMIT

CITY OF NAPOLEON, OHIO — DEPT. OF BUILDING & ZONING  
255 W. Riverview Avenue, Napoleon, Ohio 43545 (419) 592-4010

Permit No. 503 Date Sept. 8, 1982  
Job Location 330 Rohrs St. Valuation \$ 3,000.00  
Owner Clarence R. Adams Address 330 Rohrs St.  
Contractor Clarence R. Adams Telephone No. 592-5333  
Address 330 Rohrs St., Napoleon, Ohio  
Electric Contractor Clarence R. Adams  
Plumbing Contractor \_\_\_\_\_  
Mechanical Contractor \_\_\_\_\_

This permit is issued for work described in the plans, specifications, and/or application submitted, as approved by the Building Commissioner of the City of Napoleon, Ohio. Work shall conform to all pertinent construction and land use Codes and Ordinances.

### Work Information:

Residential  Commercial \_\_\_\_\_ Industrial \_\_\_\_\_  
New Construction  Addition \_\_\_\_\_ Remodel \_\_\_\_\_  
Brief Description of Work new garage

ISSUED BY \_\_\_\_\_ DEPT. OF BUILDING & ZONING

It is the owners or contractors responsibility to call the Building Department for the following (X) inspections:

- Footing excavation prior to placing concrete.
- \_\_\_\_\_ Footing drains and foundation prior to backfill.
- \_\_\_\_\_ Prepared sub-grade prior to placing concrete floor slab.
- \_\_\_\_\_ Sanitary sewer
- Rough-in electrical, plumbing and service framing prior to installing wall board.
- Final electrical, plumbing and heating.
- Final building inspection, prior to occupancy.

### PERMIT & FEES

Building Permit	\$ <u>12.00</u>
Electrical Permit	\$ <u>7.00</u>
Plumbing Permit	\$ _____
Mechanical Permit	\$ _____
Demolition Permit	\$ _____
Zoning Permit	\$ _____
Sign Permit	\$ _____
Water Tap	\$ _____
Sewer Tap	\$ _____
Temp. Elec.	\$ _____
Other _____	\$ _____
TOTAL FEES	\$ <u>19.00</u>
LESS FEES PAID	\$ <u>19.00</u>
BALANCE DUE	\$ <u>-0-</u>

Permit is not valid until all fees are paid in full, and shall be void if work is not started within six months of date above.

# INSPECTION RECORD

UNDERGROUND			ROUGH-IN			FINAL		
Type	Date	By	Type	Date	By	Type	Date	By
<b>PLUMBING</b>	Sewer Connection		Drainage, W. & Vent			Drainage, W. & Vent		
	Building Sewer		Water Piping			Water Heater		
	Water Piping		Condensate Lines			Backflow Prevention		
			Indirect Waste					
<b>ELECTRICAL</b>	Floor Ducts Raceways		Rough Wiring			FINAL APPROVAL		
	Conduits & or Cable		Conduits/ Cable			Electric Mtr. Clearance		
	Grounding & or Bonding		Service Panel Switchboard			Signs		
			Subpanels					
			<input type="checkbox"/> Range <input type="checkbox"/> Dryer				FINAL APPROVAL	
			Refrigerant Piping				Duct Insulation	
<b>MECHANICAL</b>	Ducts/ Plenums		Ducts/ Plenums			Chimney(s)		
			Ventilation <input type="checkbox"/> Supply			Furnace(s)		
			<input type="checkbox"/> Exhst.			FINAL APPROVAL		
	Location, Set-backs, Esmt(s)		Wall Construction			Fireplace Chimney		
<b>BUILDING</b>	Excavation		Crawl Space <input type="checkbox"/> Vent <input type="checkbox"/> Access			Attic <input type="checkbox"/> Vent <input type="checkbox"/> Access		
	Footings & Reinforcing		Floor System(s)			Special Insp Reports Rec'd		
	Sub-soil Drain		Roof System			Smoke Detector		
	Foundation Walls		Fire Wall(s)			Demolition (sewer cap)		
	Floor Slab		Roof Cover Roof Drain			Building or Structure		
	FINAL APPROVAL BLDG. DEPT		—	Certificate of Occupancy Issued		#		

11/2/83  
DAG